

# Talgo 350



Talgo 350

*Talgo*

# TRACTION UNIT

# Talgo 350



## TECHNICAL SPECIFICATIONS

● Power supply	25 kV, 50 Hz
● Power installed	4000 kW
● Power equipments	Two identical and independent
● Bogies	Bo - Bo
● Wheelbase	2.65 m (8.7 feet)
● Front design	Aerodynamic. Optimized for pressure waves and lateral winds
● Pneumatic brake equipment	Three disc brakes per axle (two of them on the wheels)
● Electric brake equipment	Regenerative (4200 kW) and rheostatic (3200 kW)
● Length	20 m (65.6 feet)
● Maximum width	2.96 m (9.7 feet)
● Height	4 m (13.1 feet)

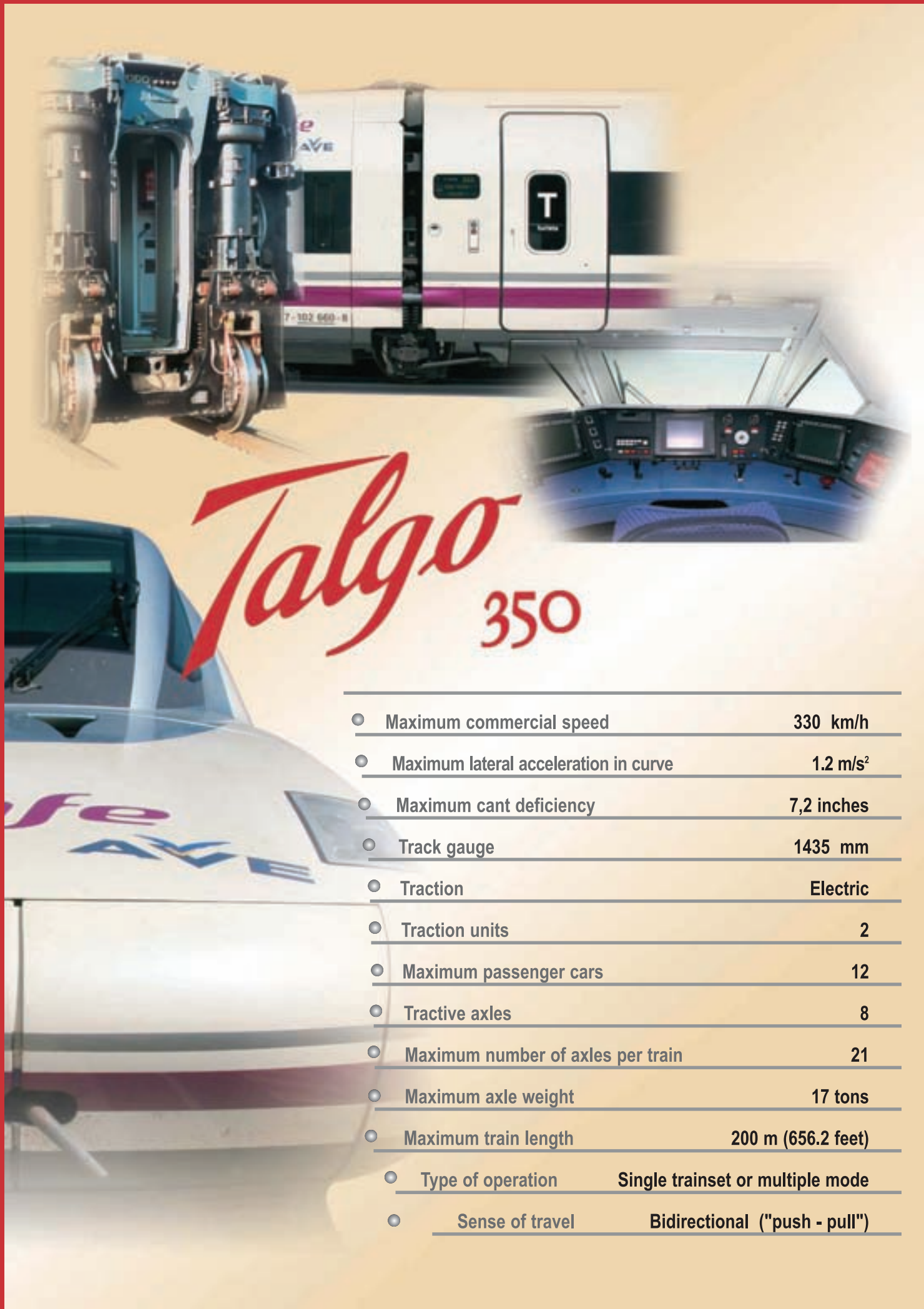

# Talgo

## 350

●	Maximum commercial speed	330 km/h
●	Maximum lateral acceleration in curve	1.2 m/s <sup>2</sup>
●	Maximum cant deficiency	7,2 inches
●	Track gauge	1435 mm
●	Traction	Electric
●	Traction units	2
●	Maximum passenger cars	12
●	Tractive axles	8
●	Maximum number of axles per train	21
●	Maximum axle weight	17 tons
●	Maximum train length	200 m (656.2 feet)
●	Type of operation	Single trainset or multiple mode
●	Sense of travel	Bidirectional ("push - pull")



# COACHES



- **CARBODIES** Lightweight, airtight, pressurized for tunnels and crossings. Very low weight per seat.
- **COUPLING BETWEEN CARS** Articulated with anti-overturning and anti-vertical hunting mechanisms.
- **CENTER OF GRAVITY** Very low, improving stability on travel.
- **ROLLING ASSEMBLIES** Single axles, with independent wheels and primary suspension, located between cars.
- **ROLLING ASSEMBLY AXLES** Permanently steered that keep the wheels parallel to the track on both straight and curved stretches.
- **MAIN SUSPENSION** Talgo Pendular type, pneumatic, with natural carbody tilting.
- **BRAKING** Pneumatic over four discs per shaft. Anti-lock brake system.
- **AIR-CONDITIONING UNITS** Located underframe. In Club Class, a personal controlled nozzle per seat.
- **SAFETY AND CONTROL** Intelligent computerized system for continuous control of on-board systems.
- **ACCESSIBILITY** Platform height close to the level of the floor of the car. 815 mm passageway between cars.
- **SEATS** Reclining and rotating. Equipped with footrests.
- **PASSENGER COMMODITIES** Video and individual audio with channel selector (4 music channels and 2 video channels) and sound volume control. In Club Class, individual video screens with three channel selections. Interior and exterior electronic information panels. GPS-based passenger information system. Automatic audio and video information notices.
- **SEAT PRIVACY** Individual reading lights and tables. Power outlets for laptop computers or mobile telephones.
- **CAR TYPES** Club class (14/26 seats), First Class (26 seats), Bistro cars, and Coach Class (36 seats). Coach Class cars with special facilities for wheelchair-bound passengers.



# Tal



**COACH CLASS END CAR**



**COACH CLASS**

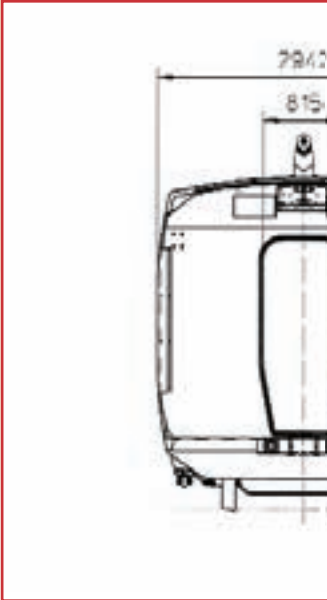

**TRANSVERSAL SECTION**

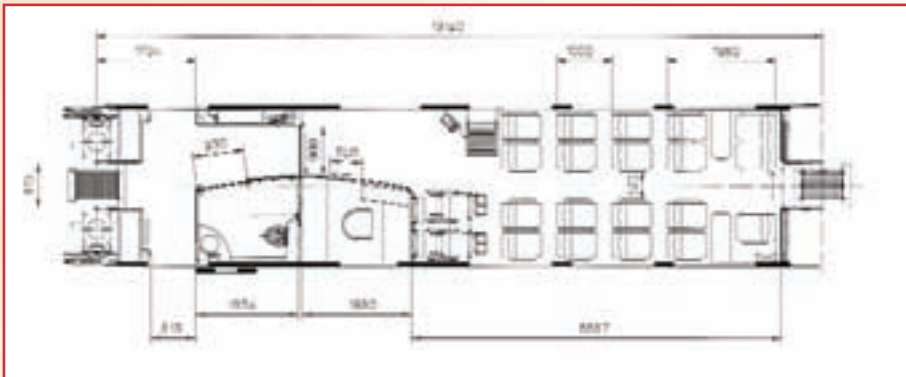

**COACH CLASS (HANDICAPPED)**

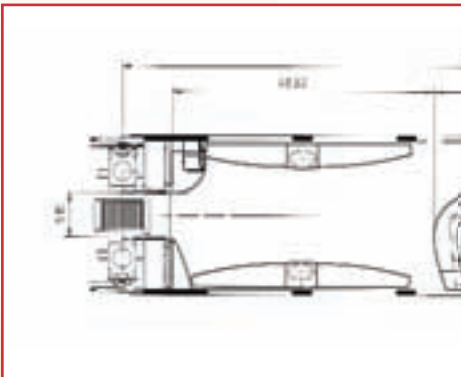

**BISTRO CARS**

**COACH CLASS**

**COACH CLASS (HANDICAPPED)**

**BISTRO CAR**



# go

## 350

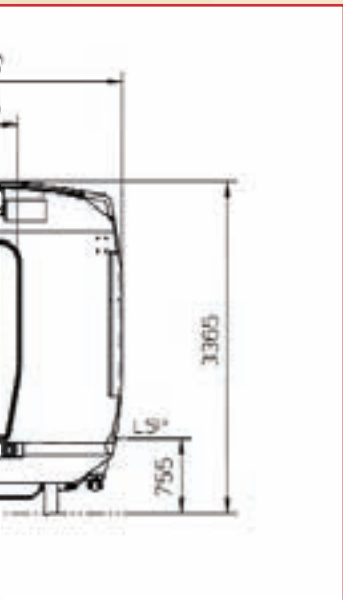

SECTION

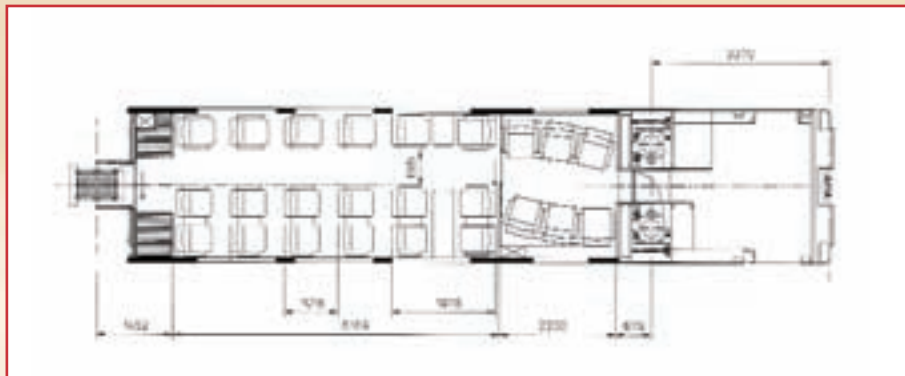

CLUB CLASS END CAR

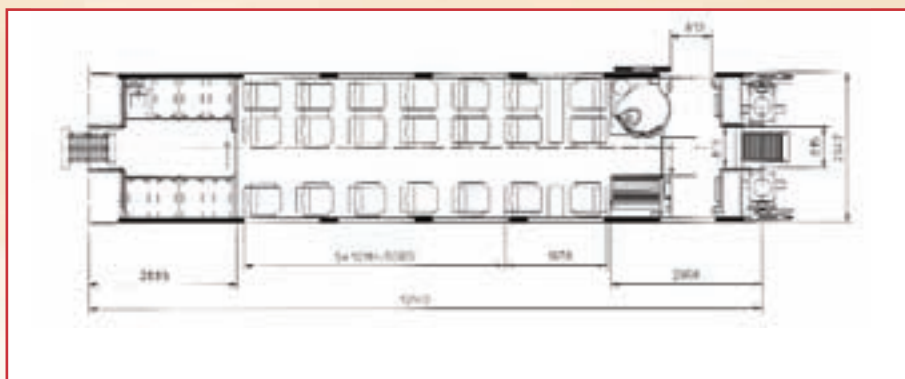

CLUB CLASS

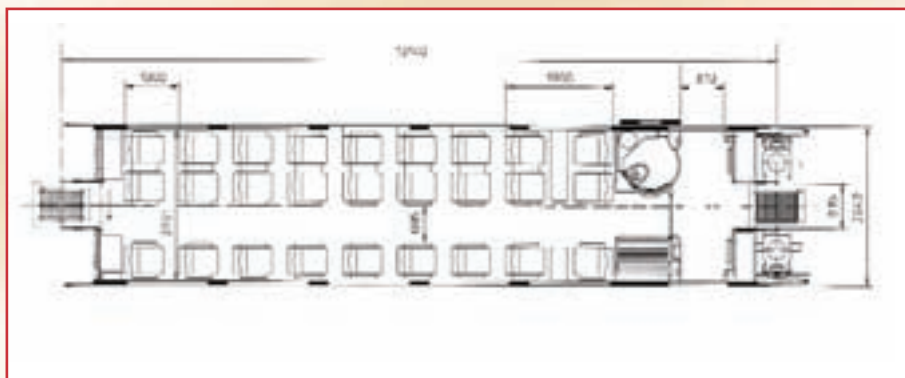
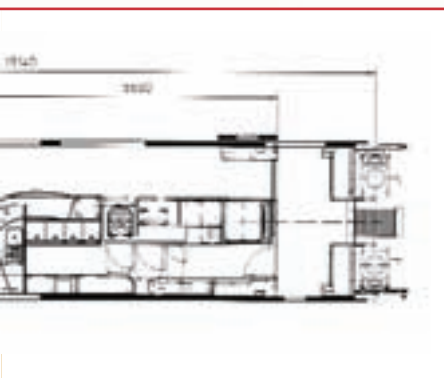

FIRST CLASS

S

FIRST CLASS

CLUB CLASS

C







## **MAIN IMPROVEMENTS**

Optimised aerodynamic design

High degree of redundancy in traction and auxiliary systems

Single-axle wheelsets between coaches

Permanently guided wheelsets with independent wheels

Articulated union between coaches

Light weight construction

Natural tilting system

Rotating seats

## **Talgo 350 Laboratory train**

This Talgo 350 model is a laboratory train for international standard gauge tracks. Its main functions are dynamic and geometric examination of the track and catenary; checks and monitoring tools for ASFA and ERTMS signalling systems and GSM-R ground-train communication systems, real-time checks of aerodynamic phenomena occurring in tunnels, simulations to measure journey times for commercial use and infrastructure equipment validation.



**CLUB CLASS END CAR**

**TRACTION UNIT**





## COMPANIES IN THE GROUP:

### USA

#### Talgo, Inc. Offices

##### Seattle

505 Fifth Avenue South, Suite 170  
Seattle, WA 98104  
Tel: (+1) 206 748 6140  
Fax: (+1) 206 748 6147  
www.talgoamerica.com

##### Manufacturing

3533 North 27th Street  
Milwaukee, WI 53216  
Tel: (+1) 414 977 4836  
Fax: (+1) 414 445 6735

##### Maintenance Facility - Seattle

1717 3rd Avenue South  
Seattle, WA 98134  
Tel: (+1) 206 748 6140  
Fax: (+1) 206 748 6147

##### Other offices:

Miami, FL  
Washington D.C.

### GERMANY

#### Talgo Deutschland GmbH

Revaler Strasse 99  
D-10245 Berlin  
Tel: (+49) 302 388 000  
Fax: (+49) 302 388 0011  
info@talgo.de  
www.talgo.de

### KAZAKHSTAN

#### Talgo Kazajstán

Polezhaeva 1 a  
KZ-050016 Almaty  
Tel: (+7) 727 296 13 13  
Fax: (+7) 727 296 19 24

### BOSNIA AND HERZEGOVINA

#### Talgo BH d.o.o

Danijela Ozme 1  
71000 Sarajevo  
Bosnia and Herzegovina  
Tel: (+387) 33 26 11 55  
Fax: (+387) 33 26 11 56

## TALGO IN SPAIN:

### MANUFACTURING PLANTS:

#### Madrid - Las Matas II

Paseo del Tren Talgo nº 2  
28290 - Las Matas (Madrid)  
Tel: (+34) 91 636 91 50  
Fax: (+34) 91 630 92 48

#### Álava - Rivabellosa

Río Bayas, 5.  
01213 - Rivabellosa (Álava)  
Tel: (+34) 94 535 52 30  
Fax: (+34) 94 535 51 73

### MAINTENANCE FACILITIES:

#### Madrid - Las Matas I

Ctra. N-VI, Km. 23,500  
28230 - Las Matas (Madrid)  
Tel: (+34) 91 636 91 50  
Fax: (+34) 91 636 15 02

#### Madrid - Fuencarral

C/ Antonio de Cabezón s/n  
28034 - Madrid  
Tel: (+34) 91 728 22 07  
Fax: (+34) 91 722 22 10

#### Madrid - Santa Catalina

Santa Catalina 14  
28053 - Madrid  
Tel: (+34) 93 785 65 34  
Fax: (+34) 93 785 65 86

#### Málaga

Camino de los Prados  
C/ Ucrania s/n  
29006 - Málaga

#### Barcelona - Can Tunis

C/ Motor s/n  
08040 Barcelona  
Tel: (+34) 93 336 83 30  
Fax: (+34) 93 274 26 65

#### Barcelona - San Andres

Ferrán Junoy s/n  
08030 Barcelona  
Tel: (+34) 93 274 52 93  
Fax: (+34) 93 311 49 57

## HEADQUARTERS:

## SPAIN

### TALGO

Paseo del Tren Talgo Nº 2  
28290-Las Matas (Madrid)  
Tel: (+34) 91 631 38 00  
Fax: (+34) 91 631 38 93  
marketing@talgo.com



[www.talgoamerica.com](http://www.talgoamerica.com)  
[www.talgo.com](http://www.talgo.com)